

- Tested according to the fall protection equipment standards EN 795:2012 Type A + C and CEN/TS 16415:2013 Type A + C.
- CE marked.
- Made of stainless steel/powder coated.
- Dimensioned so that the loop remains at least 300 mm above the roof surface.
- Installed to load-bearing trapezoidal sheet. The fasteners are included with the roof anchor post.
- Can be used as an individual anchor point or as part of a lifeline system. Max 4 users at the same time.

Alternative: PITO™ Greenline
lifeline system

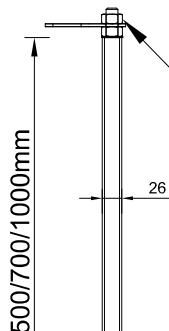
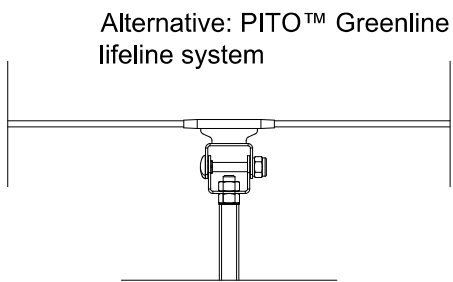

When fitting the nut, use the
assembly lubricant supplied with the anchor point
Tighten so that the loop locks between the nuts.

INSTALLATION FROM ABOVE

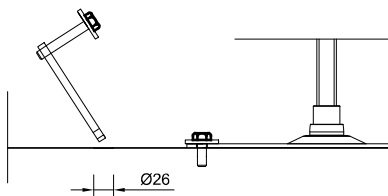

Mounting hole Ø26mm

The mounting plate is installed through this hole

Bolt M12-L70 mm, 8.8

Torque 30 Nm

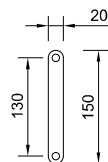

M12 bolt + mounting plate 10x20x150,
with bolt threads

330

Hole Ø 13 mm
Bolt M12-L35 mm, 8.8
Torque 30 Nm

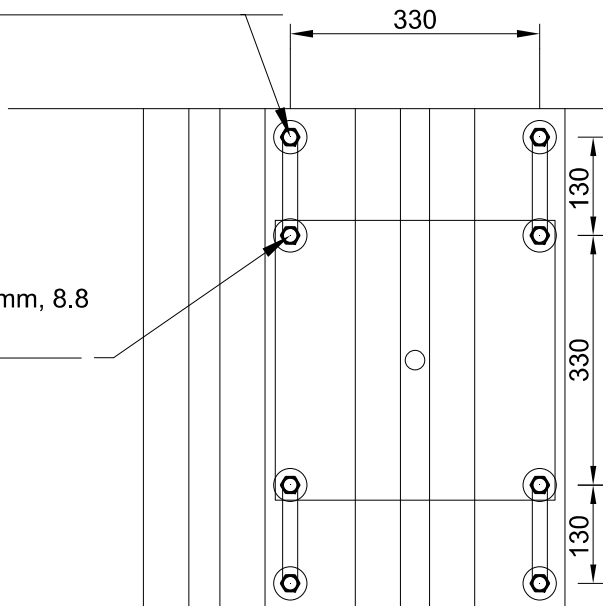

ALTERNATIVE INSTALLATION
ACCORDING TO SPACING OF
RIDGES ON TRAPEZOIDAL SHEET

